

# meetings and events

Adding Color to Life<sup>SM</sup>

The Radisson logo is written in a stylized, cursive black font with a blue underline. It is positioned on the right side of a blue and pink horizontal bar that spans across the middle of the page.

## Rooms Accommodations

- › Two LCD Televisions
- › Mini Refrigerator & Microwave
- › Coffee Maker, complimentary coffee/tea
- › In-room Safe
- › Fireplace
- › Separate Living/Working area, full size desk
- › Complimentary Bottled Water & Newspaper
- › Also available – Deluxe Whirlpool Suites and 1,500 Sq. Ft. multi-room, multi-level Suites

## Location

- › From Highway 401 exit at 410 North, exit at Derry Road West, pass Kennedy Road we are on the right hand side (on Derry Road East)
- › Conveniently located within a short drive from:
  - Pearson International Airport
  - Hershey Centre
  - The Powerade Centre
  - Derrydale Golf Course
  - Peel Golf Course
- › 35 minutes from downtown Toronto, CN Tower
- › Close to World-class Shopping (Square One, Heartland), Dining and more...

## Park Inn by Radisson

175 Derry Road East, Mississauga, ON, L5T 2Z7  
T: +1 (905) 364-9999, F: +1 (905) 364-9990  
pd\_twon@parkinn.com

## Hotel Features

- › Complimentary High Speed Internet
- › Complimentary use of Business Centre
- › Complimentary use of Fitness Centre and Indoor Pool
- › Complimentary Parking
- › Complimentary Shuttle Service to / from airport
- › Full Service Restaurant and Lounge, or Room Service
- › Indoor Pool and Hot Tub

## Meeting Facilities

- › Grand Victorian Convention Centre, with 9 function rooms totalling 13,000 Sq. Ft.
- › State of the Art Audio Visual System
- › Built in Screen and Projectors
- › State of the Art Sound System, Intelligent Lighting
- › Live Streaming Capability
- › Unique Roof Top Garden and Meeting Room



# Meeting Rooms

## Grand Victorian Convention Centre

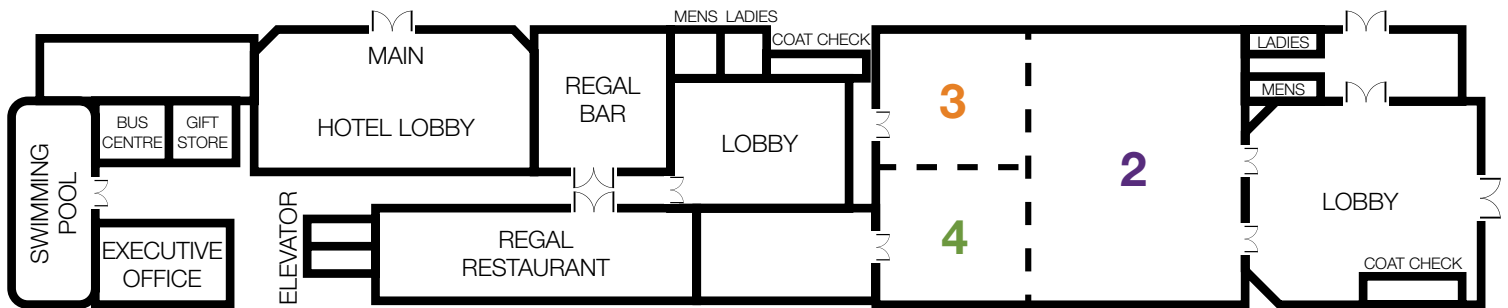

## Lower Level

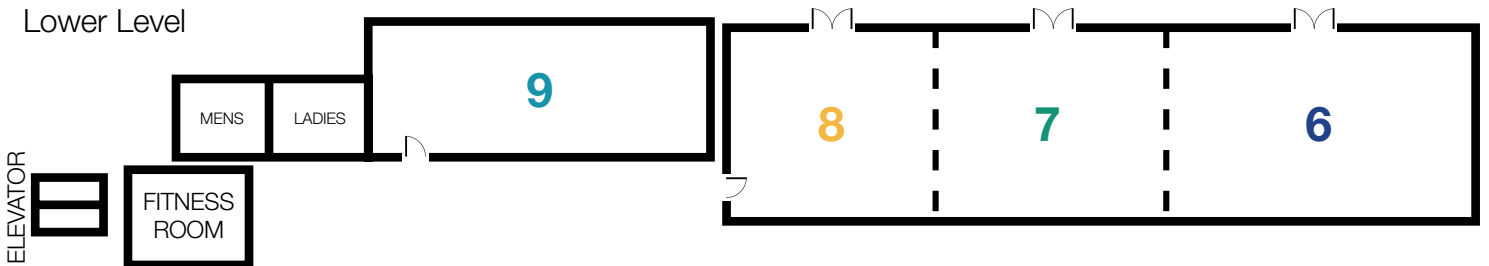

## 3rd floor

Garden View Room & Terrace (not shown)

Rooms/People	Size	Square Feet	Ceiling Height	Theatre	Banquet	Reception	Class Room	U-Shape	Hollow Square	Board Room
1 Grand Victorian	100'x70'	8056	26'	900	660	842	550			
2 Abigale	75'x63'	4756	26'	527	390	500	325			
3 Beatrice	37'x44'	1650	26'	183	136	174	114	38	44	
4 Constance	37'x44'	1650	26'	183	136	174	114	38	4	
Beatrice + Constance	42'x70'	3300	26'	366	272	347	228			
5 Prince Albert	85'x33'	2805	9'	311	232	295	192			
6 Dorothy	41'x33'	1369	9'	150	112	142	93	32	38	
7 Eleanor	24'x33'	792	9'	88	64	84	54	16	18	
8 Frederick	20'x33'	676	9'	72	50	70	45	14	16	
9 Grandville Board Room	24'x26'	632	9'	70	50	68	44	14	16	16
10 Garden View Room	50'x28'	1400	9'		112	147	96	35	38	
11 Garden Terrace (outdoor)		3000	9'	155		180				